

# LED PANEL User Manual

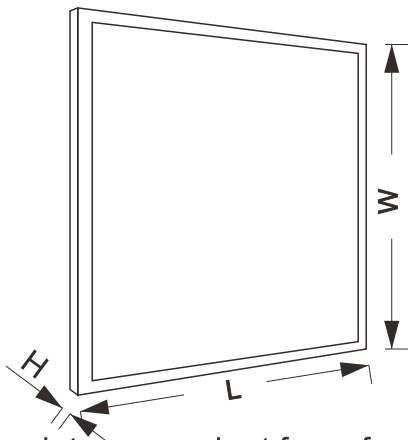

All the pictures are just for reference and we have the final explanation rights

SIZE	L X W X H (mm)	L X W X H (Inch)
<b>European Size</b>		
<b>300X300</b>	<b>295 X 295 X 10 mm</b>	<b>11.62 X 11.62 X 0.4"</b>
<b>300X600</b>	<b>295 X 595 X 10 mm</b>	<b>11.62 X 23.43 X 0.4"</b>
<b>600X600</b>	<b>595 X 595 X 10 mm</b>	<b>23.43 X 23.43 X 0.4"</b>
<b>300X1200</b>	<b>295 X1195 X 10 mm</b>	<b>11.62 X 47.05 X 0.4"</b>
<b>600X1200</b>	<b>595 X 1195 X 10 mm</b>	<b>23.43 X 47.05 X 0.4"</b>
<b>Germany Size</b>		
<b>622X622</b>	<b>622 X 622 X 10 mm</b>	<b>24.49 X 24.49 X 0.4"</b>

## Installation

\*\*\*Cut off power before installation.

For Osram Driver connect to 900mA

## Connection

\*\*\*reversing connection may cause lighting delay

For 6500K only connect White Cable: - LED      Green: + LED  
 For 2700K only connect Black Cable: - LED      Red: + LED  
 Tunable White    White Cable: C-      Green: V+  
   Black Cable: W-      Red: V+

## Recession

\*\*\*Customers can choose safety rope to avoid lamp falling caused by uncertain factors (earthquake, etc).

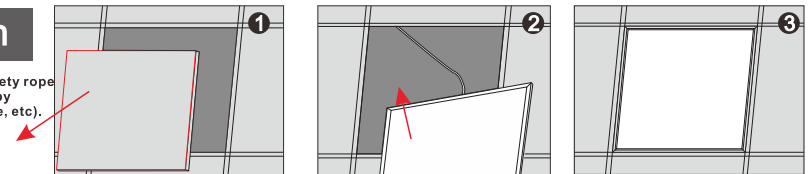

1. Remove the plasterboard from the ceiling.    2. Fix the panel into ceiling.    3. Installation finished.

## Common Failures & Solutions

Common Failures	Solutions
Light is out	① Ensure the lamp is well connected. ② Ensure the switch is turned on.
Flashing	① Ensure the Voltage is stable. ② Ensure the dimmer is compatible.

## Notes

- Indoor lighting only.
- Before installation, ensure the LED panel is not damaged.
- Don't stare at the LED luminous surface for long time.
- Keep away from children, and ensure working electrical apparatus inaccessible to them.
- No packages accessible to children, because they might be choked for playing, or eating the small accessories.
- No covering, be away from fire or high-temperature substance.
- Manufacturer reserves the right to offer no replacement or warranty to the led panels disassembled or repaired by users themselves.
- Cut off power before cleaning the panels with dry cloth, use no chemical or corrosive substance.
- Cut off power before installation.
- The light source of this luminaire is not replaceable; when the light source reaches its end of life the whole luminaire shall be replaced.