

# Hand-held Remote Controller Instructions

## 1. The introduction

Hand-held Remote Controller is the matching product for the Zigbee dimming control system. After scanning the QR code by using your phone and being bound to the lamps, the Hand-held Remote Controller can dim the light by controlling the lamps.

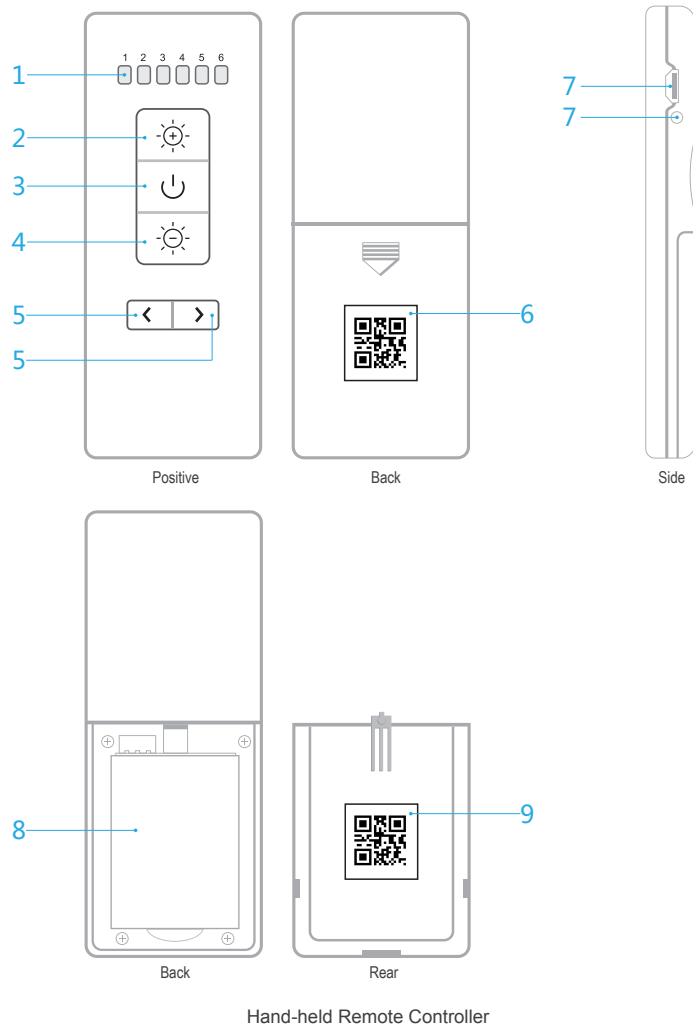

- (1) The indicator of selecting group: there are 6 indicators in total. If the light group is being selected, the indicator will light up.
- (2) The button of enhancing illumination: control the light to increase the illumination by press the button.
- (3) The switch button: press the button to turn on or off the light.
- (4) The button of reducing the illumination: press the button to reduce the illumination.
- (5) The button of group selecting: press the (left and right) buttons to select the light group you want to control.
- (6) QR code: add the product as the system device through scanning the QR code with your phone.
- (7) The charging jack and indicator: the Hand-held Remote Controller can be charged with the USB charger and the indicator will light up at that time.
- (8) Battery: the recharge battery provides the power driving for Hand-held Remote Controller.
- (9) QR code: back up (if you encounter the abrasion of the QR code on the outside, scan the QR code which is on the inside of the back shroud).

## 2. The instructions

- (1) Before using the product, make sure that battery is full of sufficient electricity. If the electricity is low, use the USB wire to charge up the battery.
- (2) Launch the application "iLightsln" and add the product as the system device by scanning the QR code.
- (3) In the network of Zigbee, enter the interface of "Setting/Binding settings" for binding the product to the lamps being controlled (a lamp or many groups of lamps). And choose the control channel of lamps (6 control channels in total, and the default channel is channel 1).
- (4) Finish binding, you can take the operations of dimming control with the product.

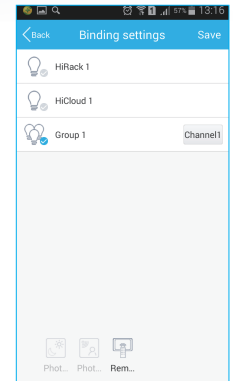

2.(3)

2.(4)

